

TITLE: SPECIFICATION CONTROL DRAWING

PART IDENTIFIER: 12-250-TP

DESCRIPTION: PILL TERMINATION

ASSEMBLY DWG: 1400214

1.0 SPECIFICATIONS:

1.1 ELECTRICAL:

- 1.1.1 IMPEDANCE: 50 OHMS NOMINAL.
- 1.1.2 FREQUENCY: DC-26.5 GHZ.
- 1.1.3 INPUT POWER (MAX @ 25°C): (DERATED LINEARLY TO ZERO POWER @ 150°C)
 - 1.1.3.1 AVERAGE: 3 WATTS.
 - 1.1.3.2 PEAK: 100 WATTS, 100US PULSE WIDTH AND 0.1% DUTY CYCLE.
- 1.1.4 VSWR: 1.35 MAX.
- 1.1.5 SCHEMATIC: SEE SHEET 2, FIG. 2.

1.2 MECHANICAL:

- 1.2.1 OUTLINE DWG: SEE SHEET 2, FIGURE 1.
- 1.2.2 WORKMANSHIP: PER MIL-D-39030.

1.3 ENVIRONMENTAL:

- 1.3.1 TEMPERATURE RANGE:
 - 1.3.1.1 NON-OPERATING: -55°C TO +150°C.
 - 1.3.1.2 OPERATING: -55°C TO +150°C.

2.0 UNIT MARKING: "12-250-TP AND EMCT"
LEGIBILITY AND PERMANENCY PER MIL-STD-130.

3.0 QUALITY ASSURANCE:

3.1 PERFORM INSPECTION IN ACCORDANCE WITH 824W170 AND 824F036 FOR COMMERCIAL GRADE PRODUCT.

3.2 TEST DATA REQUIREMENTS:

- 3.2.1 NO TEST DATA REQUIRED FOR CUSTOMER.
- 3.2.2 DATA RETENTION – 24 MONTHS.

4.0 PACKAGING: STANDARD PACK PER 755W002.

EMC TECHNOLOGY 8851 SW OLD KANSAS AVE STUART, FLORIDA 34997	CAGE CODE # 24602		DWG #	1004155000
	CHANGE NOTICE	EN 10-0911	REV LVL	E
			SHEET	1 OF 2

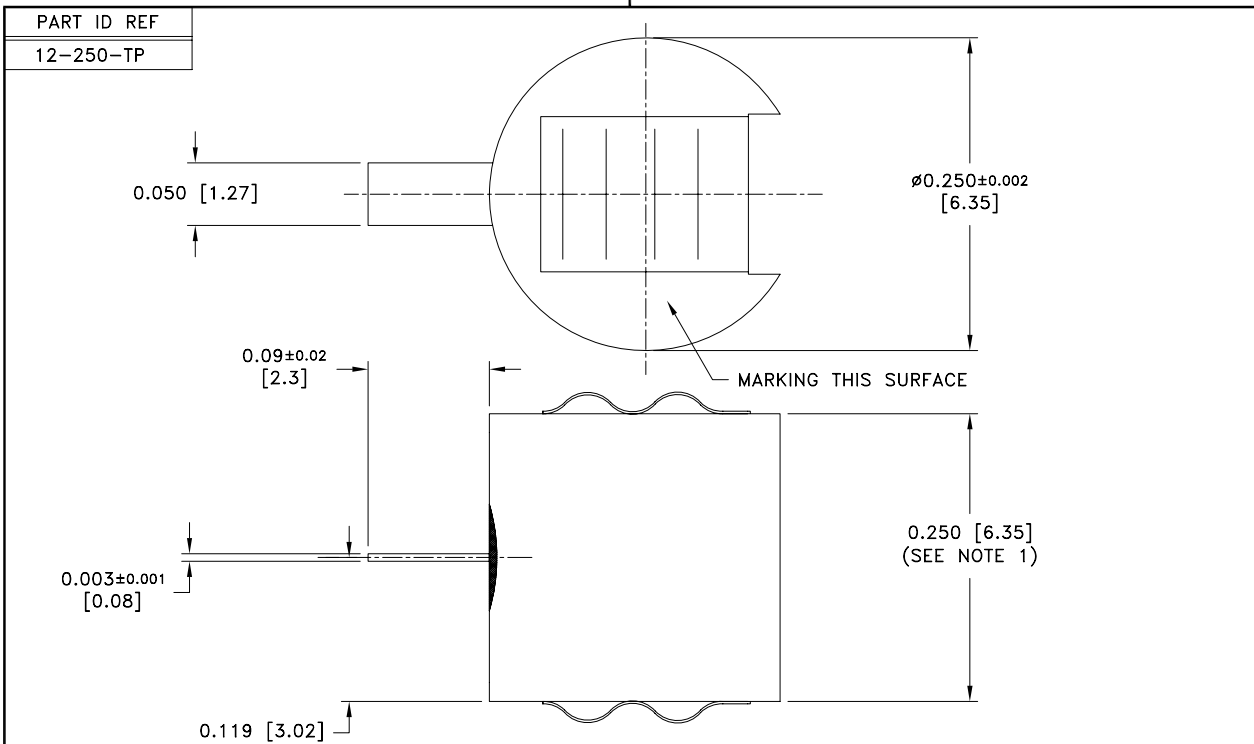

FIGURE 1

MECHANICAL SPECIFICATIONS:

METRIC EQUIVALENTS GIVEN IN [mm]
FOR REFERENCE INFORMATION ONLY

- CASE:**
 MATERIAL - BRASS, ASTM B16.
 FINISH - GOLD, MIL-G-45204, TYPE II, CLASS 1.
- TAB:**
 MATERIAL - BERYLLIUM COPPER, ASTM B197.
 FINISH - GOLD, MIL-G-45204, TYPE II, CLASS 1.
- SPRING:**
 MATERIAL - BERYLLIUM COPPER, ASTM B194.
 FINISH - GOLD, MIL-G-45204, TYPE II, CLASS 1.
- CERAMIC:**
 MATERIAL - ALUMINA, MIL-1-10.

- NOTE:**
 1. MINIMUM EXPANDED SIZE - 0.265 [6.73].
 MAXIMUM COMPRESSED SIZE - 0.246 [6.25].

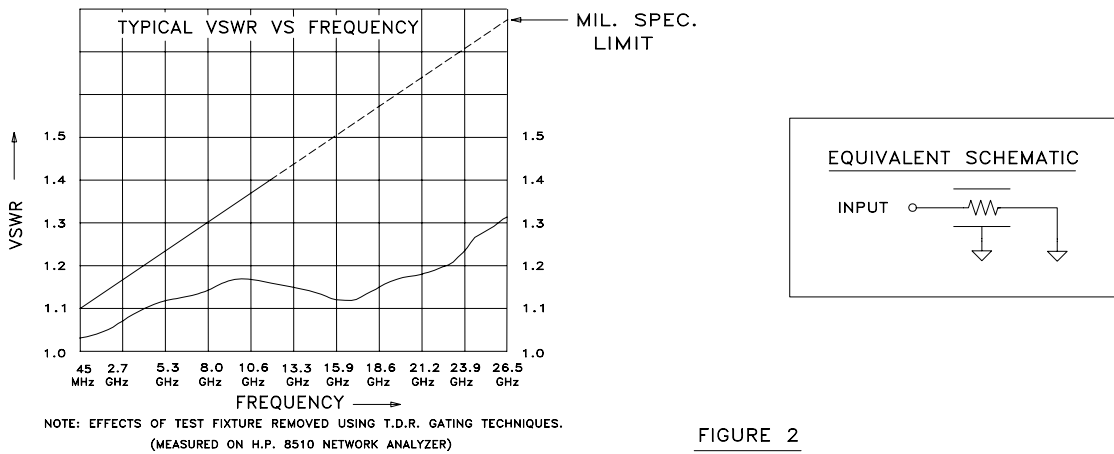
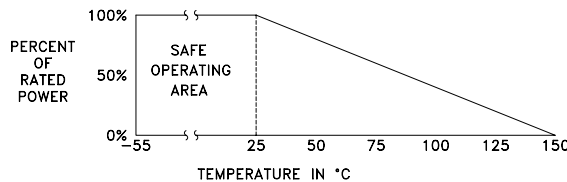

FIGURE 2

POWER RATING AND DERATING



 8851 SW OLD KANSAS AVE STUART, FL 34997 PHONE NO. (772)286-9300 FAX NO. (772)283-5286	UNLESS OTHERWISE SPECIFIED DIMENSIONS ARE IN INCHES	THESE DRAWINGS AND SPECIFICATIONS ARE THE PROPERTY OF EMC TECHNOLOGY INC AND SHALL NOT BE DUPLICATED OR USED AS BASIS FOR THE MANUFACTURE OR SALE OF PARTS OR DEVICES WITHOUT PERMISSION.					
	TOLERANCES	CAGE CODE	SCALE	DRAWN BY	CHECKED BY	APPROVED BY	
	FRACT --- --	24602	1:1	CME 08/30/2001		DAR 9/4/01	
	ANG --- --	REV	CHANGE NOTICE	DRAWING NO	SHEET		
XX ±0.01	E	EN 10-0911	1004155000	2	OF 2		
XXX ±0.005							
XXXX --- --							